

p700.2 700-754A / Transmission

ILLUSTRATION SHOWS TYPICAL PARTS ONLY. ORDER BY PART NUMBER. PARTS NOT LISTED ARE SUPPLIED BY OEM.

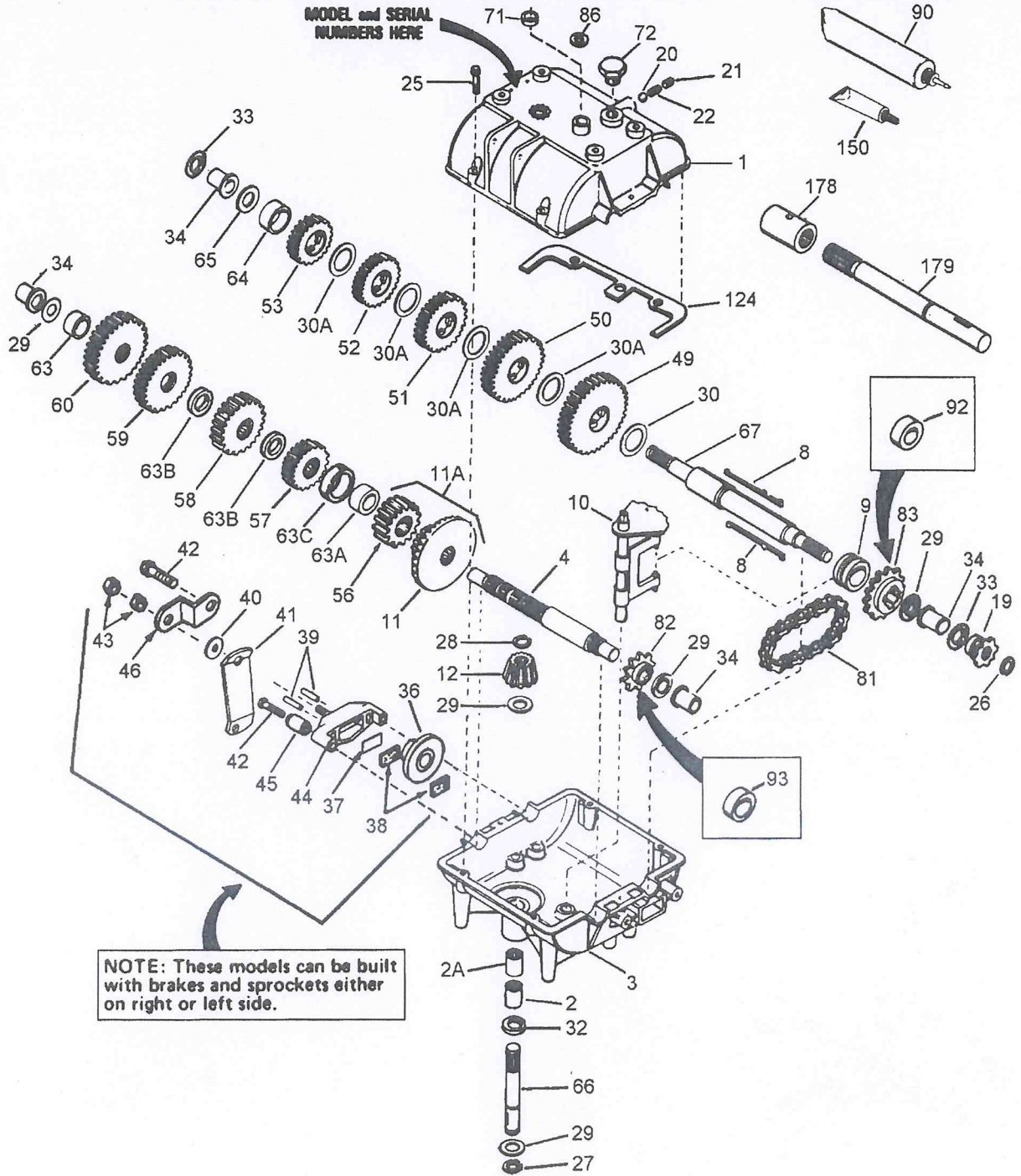

Part List

p700.2 700-754A / Transmission

REF #	ITEM #	DESCRIPTION	QTY	REMARK
1	772083A	Transmission Cover		
2	780086A	Needle Bearing		
2A	780086A	Needle Bearing		
3	770064	Transmission Case		
4	776134	Countershaft		
8	792089A	Key		
9	784266	Collar		
10	784267	Shift Rod & Fork		
11	778137A	Bevel Gear (42 teeth)		
12	778113A	Input Bevel Pinion		
19	786047	Sprocket (8 teeth)		
20	792077A	Steel Ball, 5/16"		
21	792078	Set Screw, 3/8-16 x 3/8"		
22	792079	Spring		
25	792073A	Screw, 1/4-20 x 1-1/4"		
26	792072	Retaining Ring		
27	792035	Retaining Ring		
28	788040	Retaining Ring		
29	780072	Thrust Race		
30	780108	Thrust Washer (1/16" thick)		
30A	780108	Thrust Washer (1/16" thick)		
32	792001	"O" Ring		
34	780105A	Flange Bushing		
36	790003	Brake Disk		
37	790007	Brake Pad Plate		
38	799021	Brake Pad (pkg of 2)		
39	786026	Dowel Pin		
40	792076A	Flat Washer, 5/16"		
41	790026	Brake Lever		
42	792073A	Screw, 1/4-20 x 1-1/4"		Use as requir ed
42	792085A	Screw, 1/4-20 x 2-1/4"		Use as requir ed
43	792075	Locknut, 5/16-24		
44	790020	Brake Pad Holder		
45	786092	Spacer		
49	778146A	Spur Gear (37 teeth)		
50	778124A	Spur Gear (30 teeth)		
51	778123A	Spur Gear (25 teeth)		
52	778122A	Spur Gear (22 teeth)		
53	778121A	Spur Gear (20 teeth)		
56	778145	Spur Gear (12 teeth)		

57	778126A	Spur Gear (20 teeth)	
58	778127A	Spur Gear (25 teeth)	
59	778128A	Spur Gear (28 teeth)	
60	778129A	Spur Gear (30 teeth)	
65	780109	Washer	
66	776135	Input Shaft (3-11/16" long)	
67	776217	Output & Brake Shaft	(8-13/16" long) (Shaft has four keyways and replaces shafts with two keyways. Use four keys)
72	792074	Threaded Plug	
81	786081	Roller Chain (No. 41 chain, 24 links)	
82	786082	Sprocket (9 teeth)	
83	786083	Sprocket (18 teeth)	
86	792083	Washer (Use as required)	
90	788067B	Grease	32 oz. bottle Bentonite greas e
150	510334	Gasket Eliminator (Loctite No. 515)	